

Product data sheet

Stiffy Snare Tool

This product is designed as a solution to help users and HSE personnel to reduce hazardous incidents that may occur during lifting operations. Equipped with a carbon shaft and a polyurethane cable.

- Ensures a safe distance between personnel and cargo.
- Helps position the load.
- Can control hanging loads.

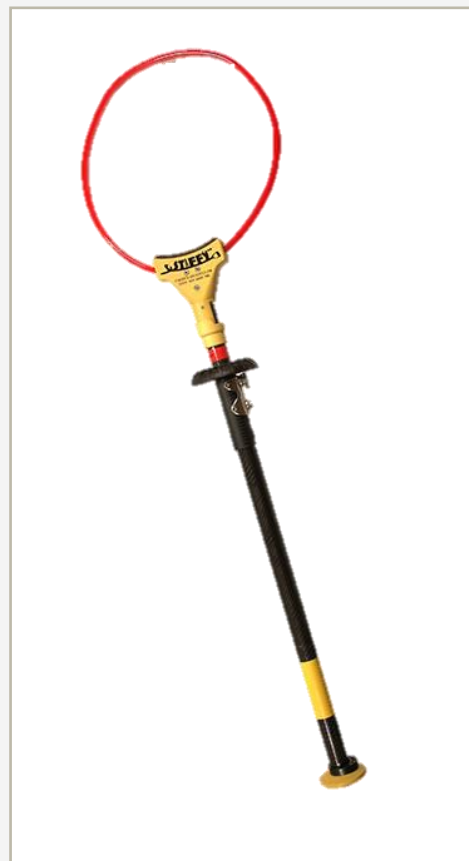

Article-number	Length inches	Length cm
0830680	24"	60
0830682	36"	90
0830684	48"	120
0830686	60"	150

Instructions

Using tool with closed loop

- 1 Slide polyurethane cable over end of load.
- 2 Grip slide handle.
- 3 Depress slide lock button.
- 4 Slide grip towards but cap to tighten polyurethane tube to load.
- 5 Guide load to desired location
- 6 Depress slide lock button and slide grip forward towards load, to release polyurethane cable.
- 7 Slide polyurethane cable off end of load.

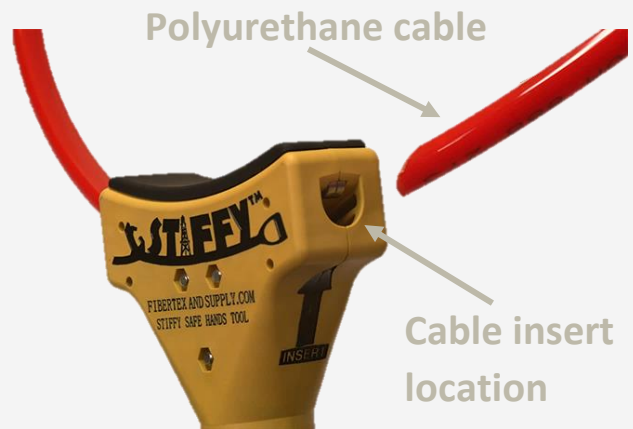

Release knob

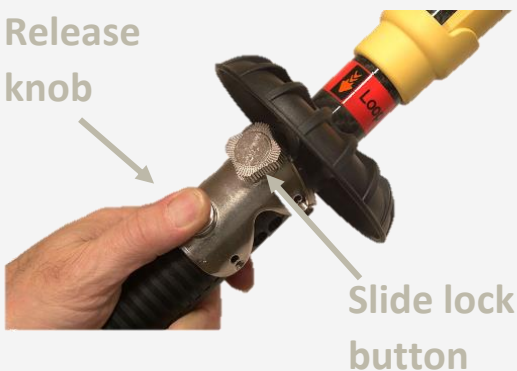

Releasing polyurethane cable

- 1 Grab slide handle, press slide lock button, slide handle forward to release tension on cable.
- 2 Pivot release knob locking lever, depress and turn release knob clockwise.
- 3 Press release and pull back on tool, cable will release from head.

Re-inserting polyurethane cable

- 1 Grab slide handle, press slide lock button and slide handle to top of shaft.
- 2 Insert polyurethane cable into tool head, (marked on side of tool head). Push in until it clicks. Depress and turn counter clockwise to locked position, pivot release knob locking lever down towards release knob.
- 3 Tool is now ready to work.

